

ENG.NO.  
W0169-1106214

B

C

A

D

E

F

1 2 3 4 5 6 7 8

Rev 版次	Revision note 變更內容	Date 日期	DR 制圖
A0	Original Release	Apr.17,10'	YangRL
A1	Update the spec	Nov.22,10'	Fanny_qu

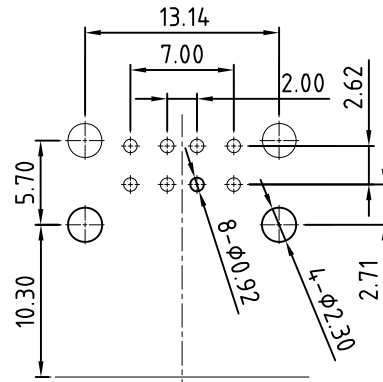
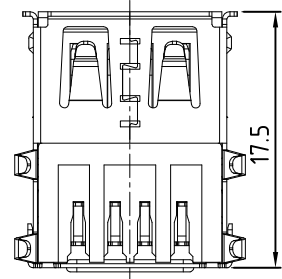
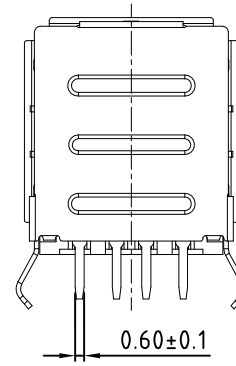
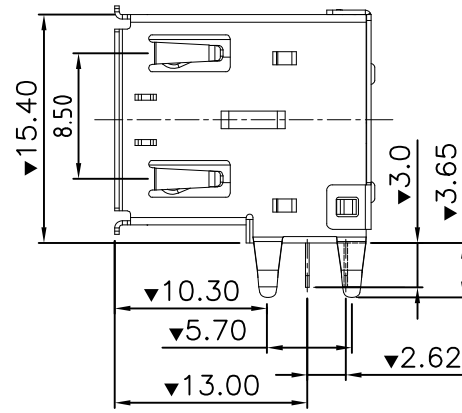
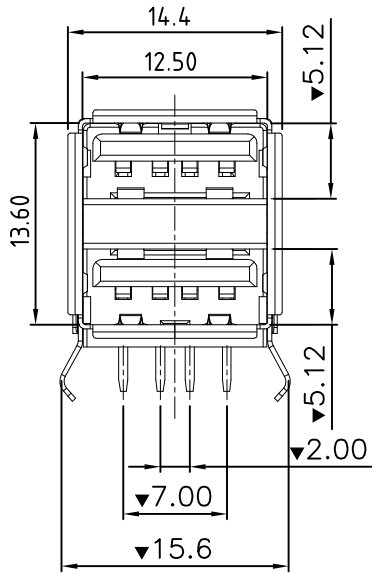
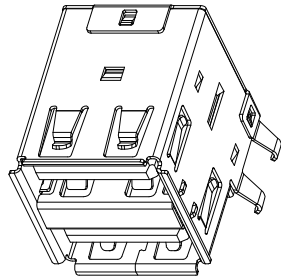
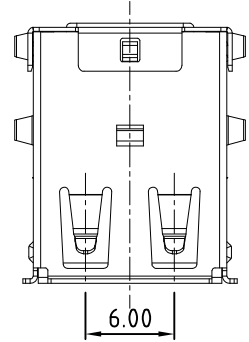

**MECHANICAL:**

1. Insertion Force: 3.57KG Max;
2. Withdrawal Force: 1.02KG Min.

**ELECTRICAL SPECIFICATION:**

1. Rated Voltage And Current: Ac 30v Max, 1.0A Per Contact.
2. Insulation Resistance: 1000 MΩ. Min.
3. Contact Resistance: 30mΩ Max.
4. Dielectric Withstanding Voltage: 500V/AC.
5. Operating Temperature: -40°C~+85°C.
6. "▼" Is Important Control Size.

**Ordering information:**

3410-AF2-RD1-XX-X

Contact Plating Code:   
 01 - TIN PLATING   
 02 - GOLD FLASH   
 03 - 3u" GOLD PLATING   
 06 - 6u" GOLD PLATING   
 10 - 10u" GOLD PLATING   
 15 - 15u" GOLD PLATING

Housing Color   
 B- BLACK   
 W- WHITE

RoHS COMPLIANT

④	BACK COVER: SPCC	1
③	SHELL:BRASS NICKEL PLATING	1
②	TERMINAL:COPPER ALLOY PLATING SEE PART NO.	8
①	HOUSING:THERMOPLASTIC UL94V-0 COLOR SEE PART NO.	1
ITEM	DESC	Q'TY

<p>威納電子 WINPOINT ELECTRONIC CORP. www.winpoint.com.tw</p>	<p>Title 名稱: DOUBLE USB,TYPE A</p>					
	<p>DR:制圖: Fanny_qu</p>	<p>CHK'D 審核: Kenny_shi</p>	<p>APP'D 核准: Chen</p>	<p>REV: A1</p>	<p>UNIT: mm</p>	<p>SHEET: 1/1</p>
<p>PART NUMBER 威納料號: Refer to ordering info</p>	<p>CUSTOMER P/N 客戶料號: -</p>	<p>DATE 日期: Nov.22,10'</p>	<p>GENERAL TOLERANCE 一般公差</p> <p>MM X.X = ±0.38 X.XX = ±0.25 X.XXX = ±0.05 UNLESS OTHERWISE SPECIFIED</p>			
<p>DWG NO. 圖號: WP009-1106036-B</p>	<p>FILENAME 路徑: WP/009</p>	<p>SCALE 比例: N/A</p>	<p>ANGULAR ±3°</p>			

A4

CUSTOMER DRAWING

THIS DRAWING CONTAINS INFORMATION THAT IS PROPRIETARY TO WINPOINT ELECTRONIC CORP. AND SHOULD NOT BE USED WITHOUT WRITTEN PERMISSION